

To remove X-Axis Sheet Metal: (*Current*)

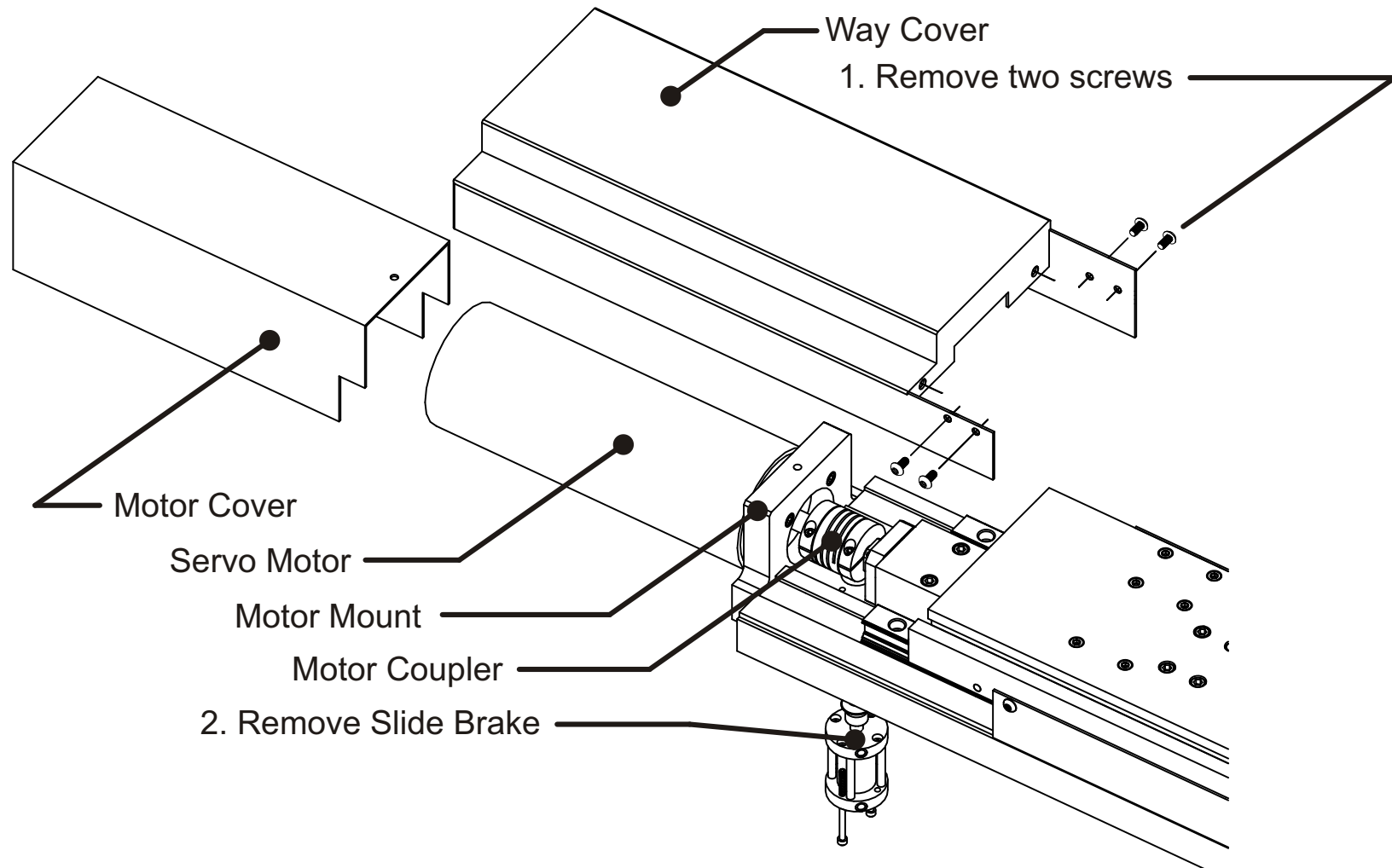

For X-Axis, the slide brake must be retracted or removed. To remove: two 6-32 cap screws secure the cylinder to the saddle. To retract, disconnect servo motor cables at controller, then turn servos ON.

To remove X-Axis Sheet Metal: (Old-style)

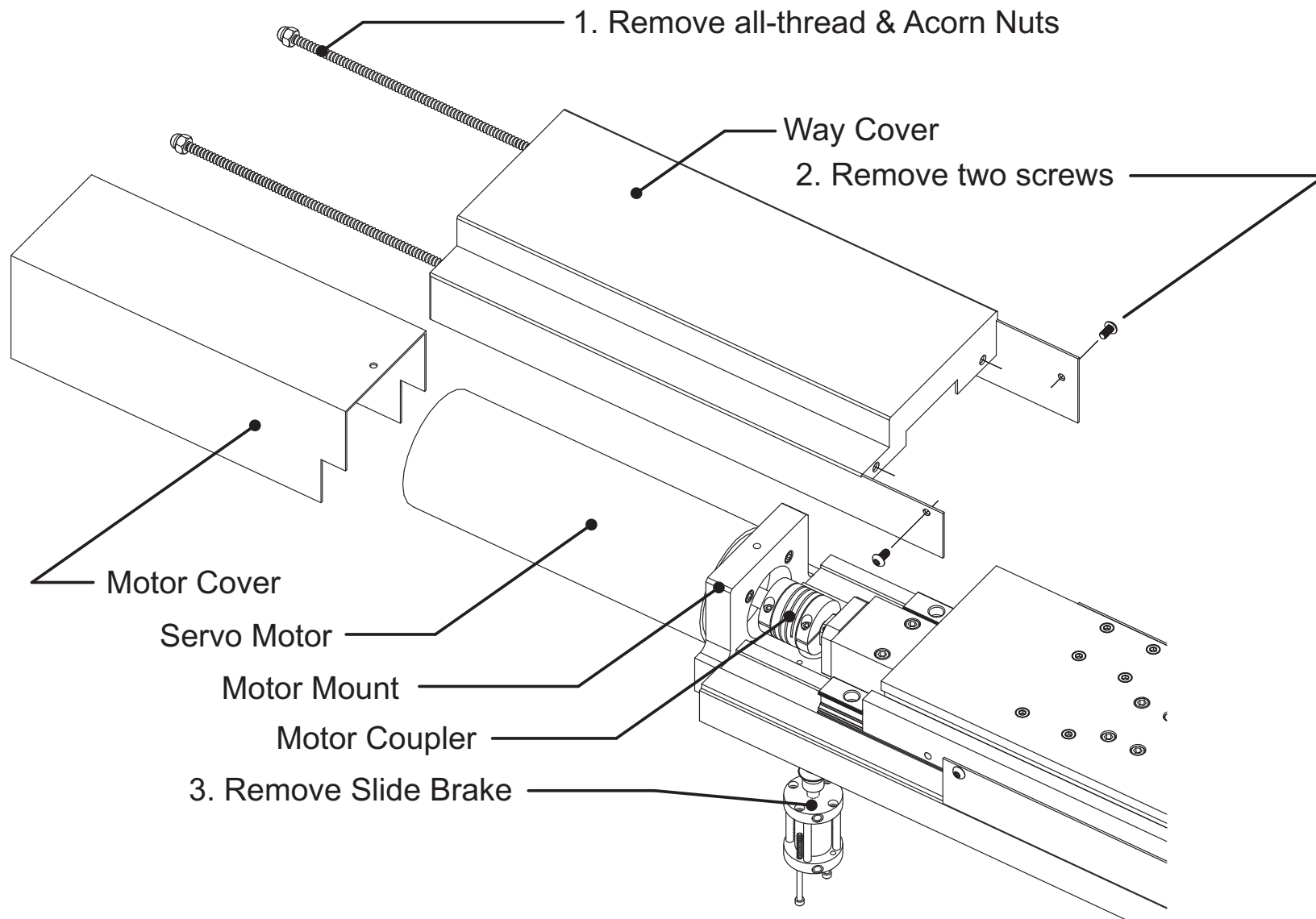

For X-Axis, the slide brake must be retracted or removed. To remove: two 6-32 cap screws secure the cylinder to the saddle. To retract, disconnect servo motor cables at controller, then turn servos ON.

To remove Z-Axis Sheet Metal: (Current)

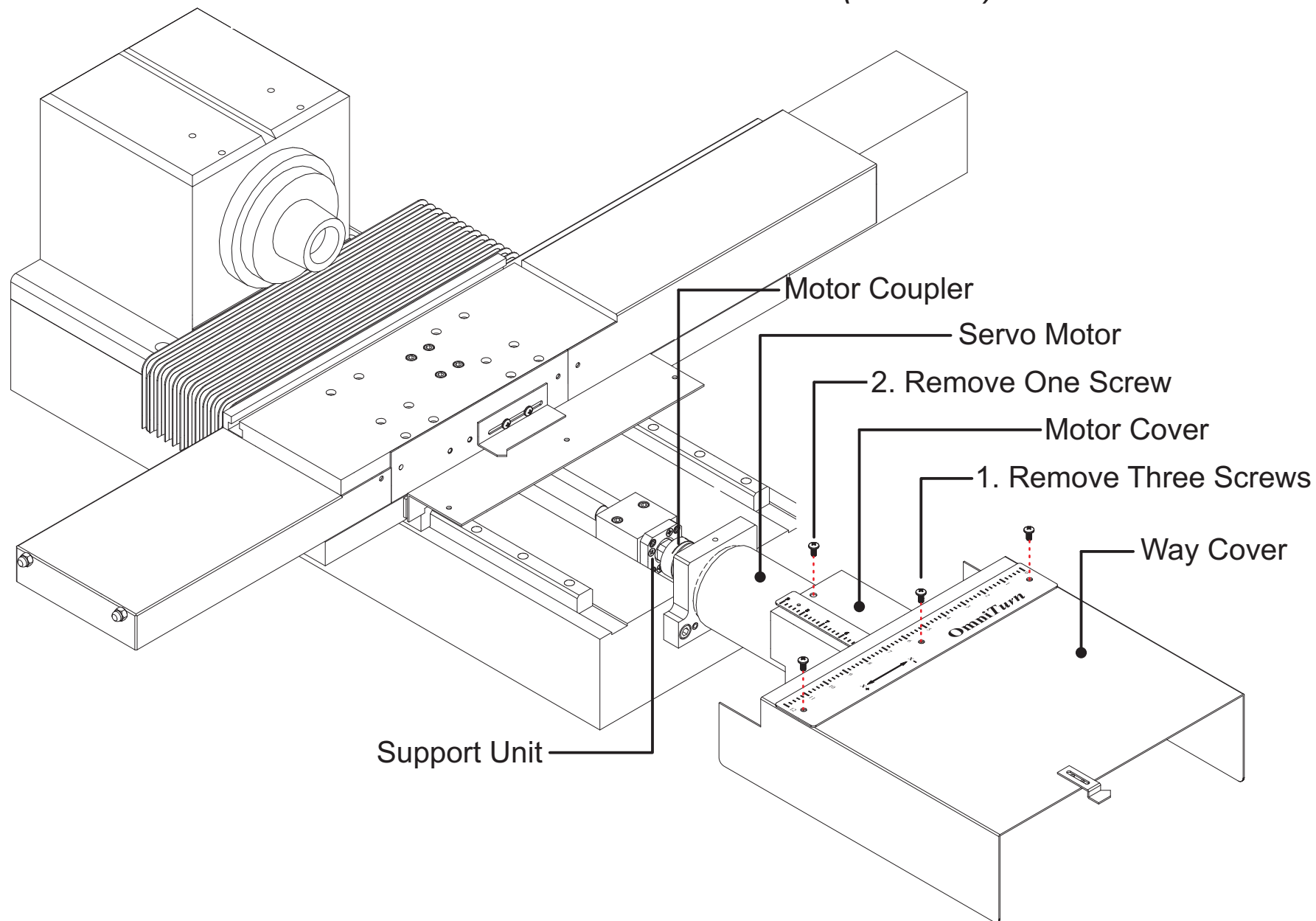

To remove X-Axis Sheet Metal: (Old-style)

