

## Remove & Replace the Tooling Plate (Table)

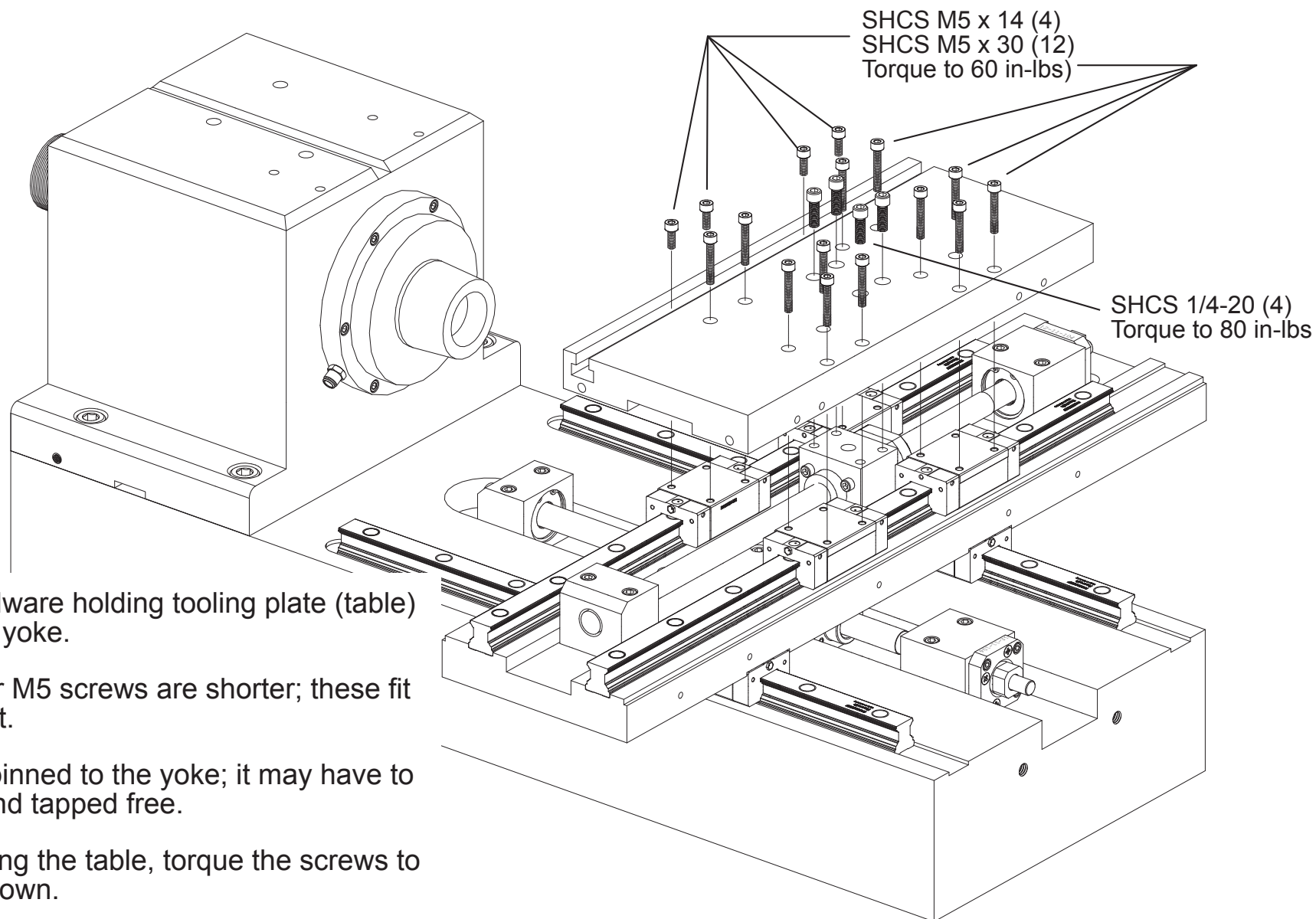

Remove hardware holding tooling plate (table) to trucks and yoke.

Note that four M5 screws are shorter; these fit holes in T-slot.

The table is pinned to the yoke; it may have to be wiggled and tapped free.

When replacing the table, torque the screws to the values shown.

## Remove & Replace X-axis Rails

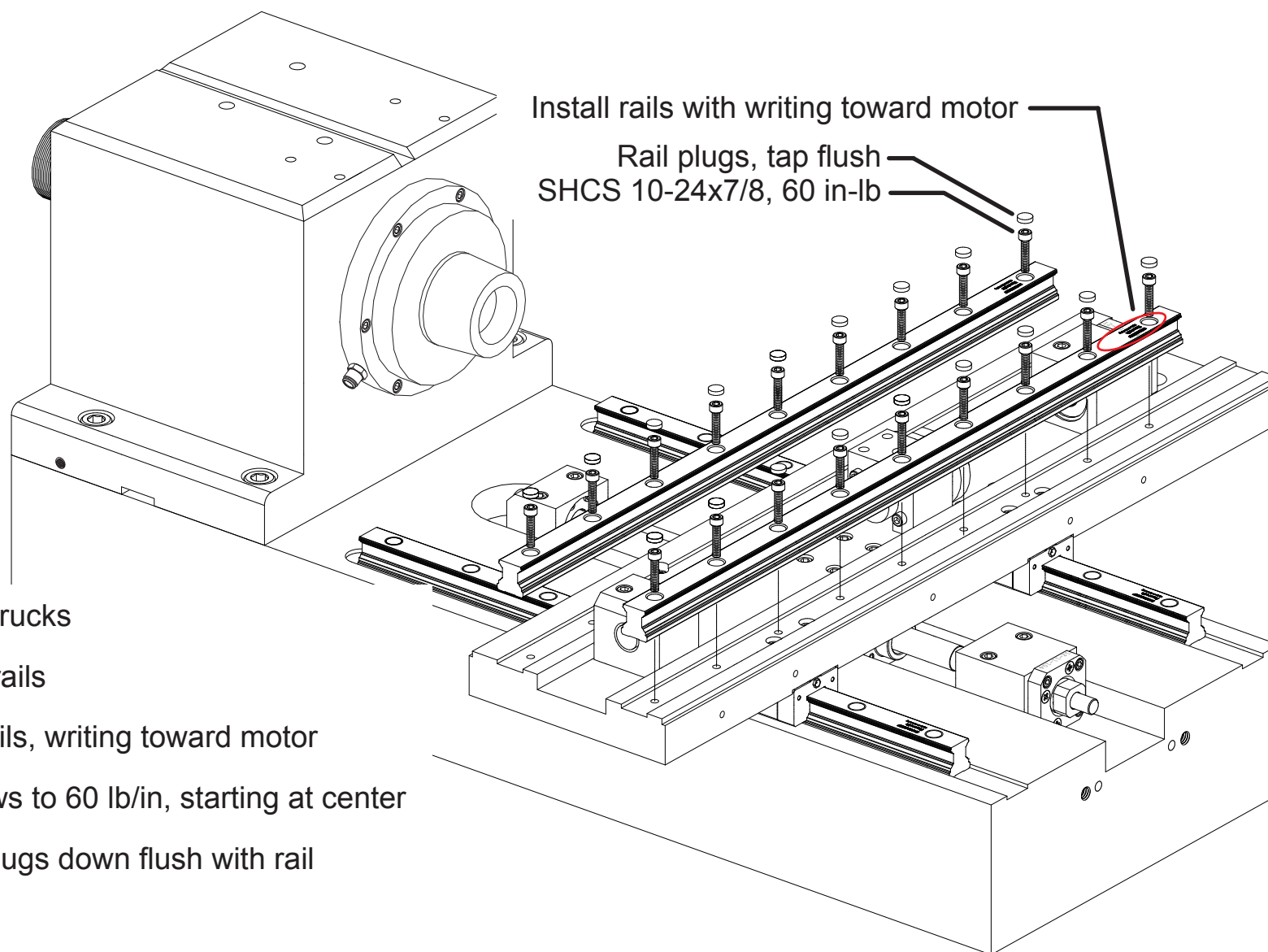

Remove old trucks

Remove old rails

Install new rails, writing toward motor

Tighten screws to 60 lb/in, starting at center

Tap the rail plugs down flush with rail

## Replace X-axis Trucks

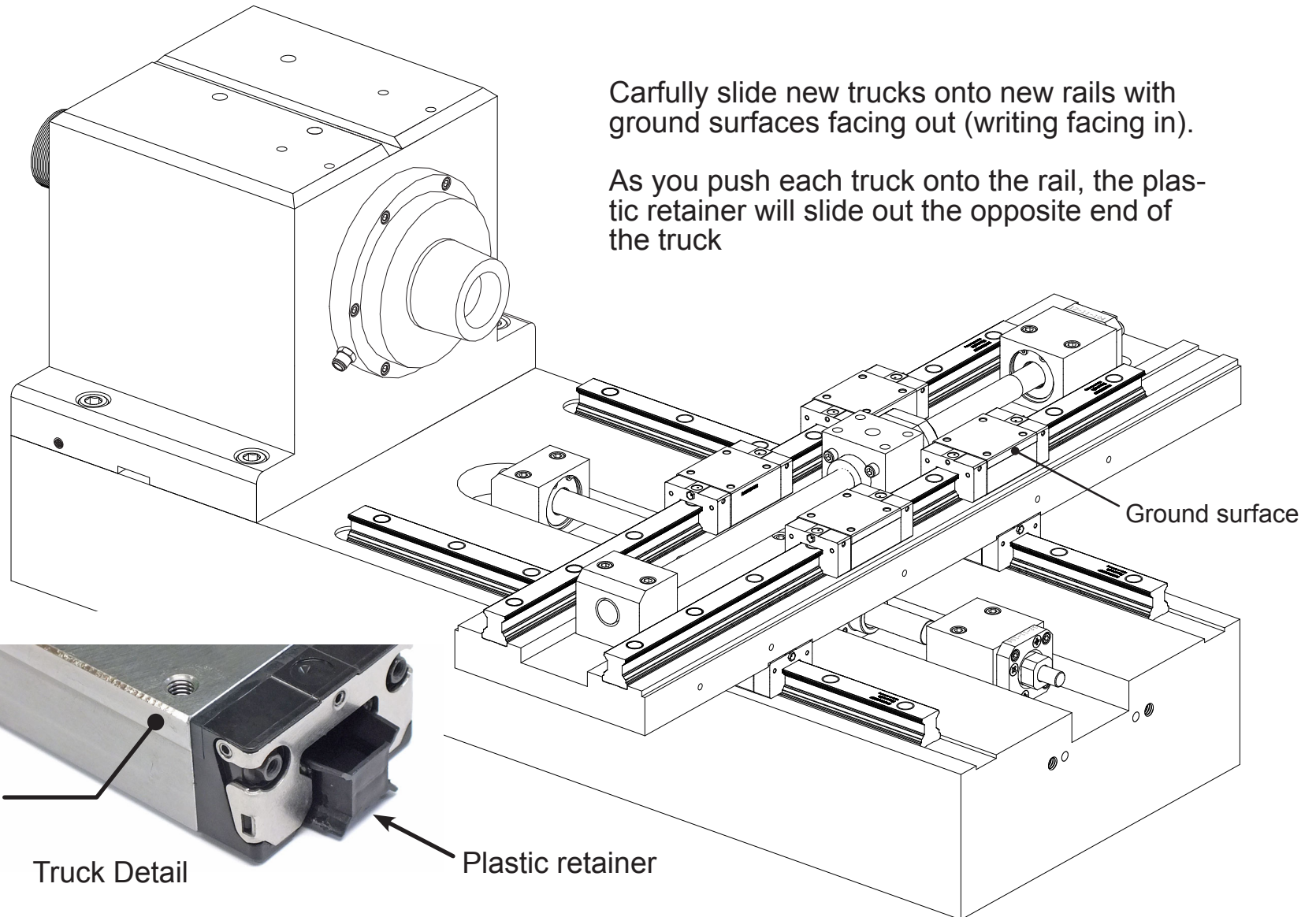

## Remove & Replace the Saddle

*Note: X-axis rails must be removed to remove saddle*

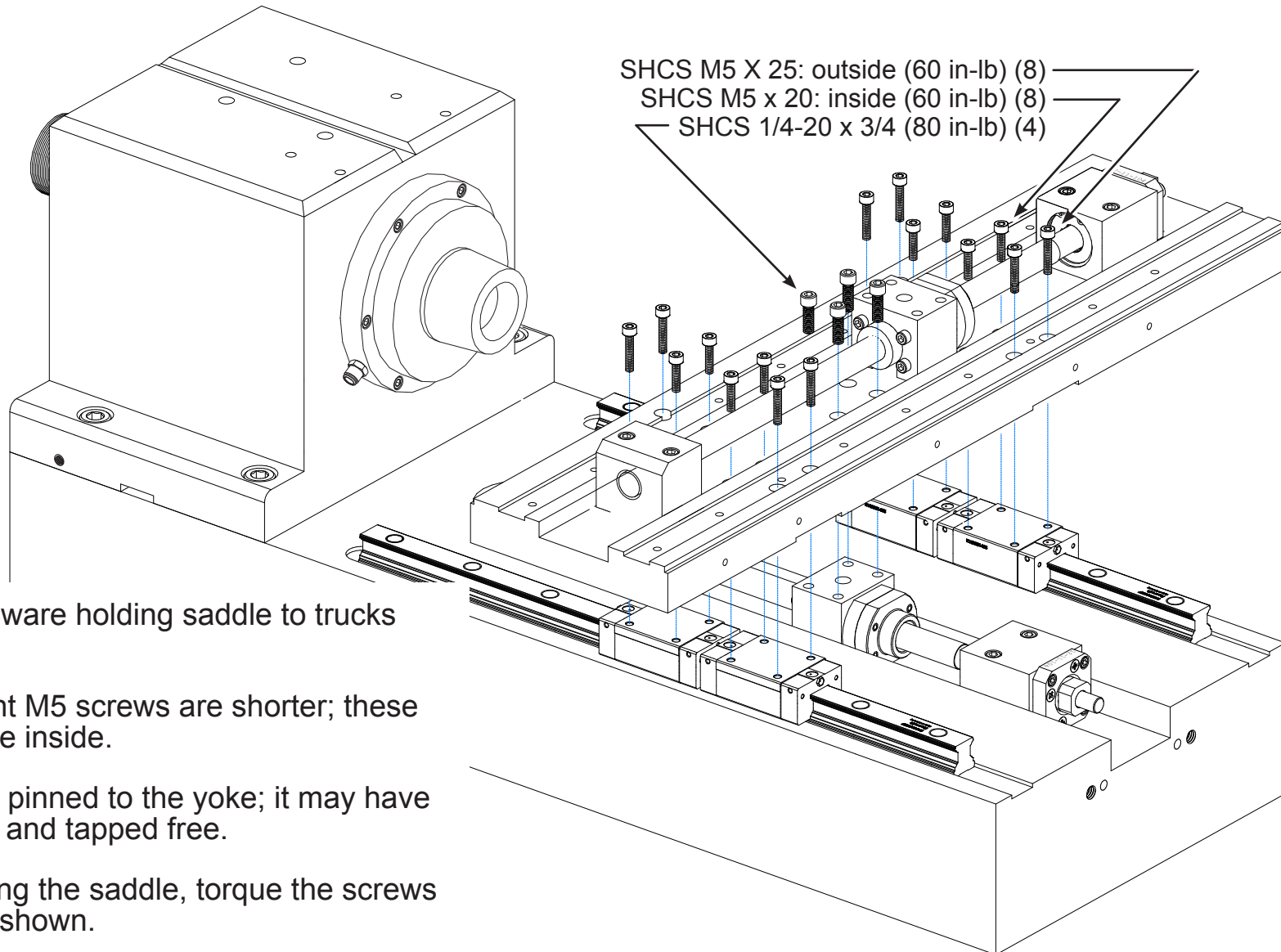

Remove hardware holding saddle to trucks and yoke.

Note that eight M5 screws are shorter; these fit holes on the inside.

The saddle is pinned to the yoke; it may have to be wiggled and tapped free.

When replacing the saddle, torque the screws to the values shown.

## Remove & Replace Z-axis Rails

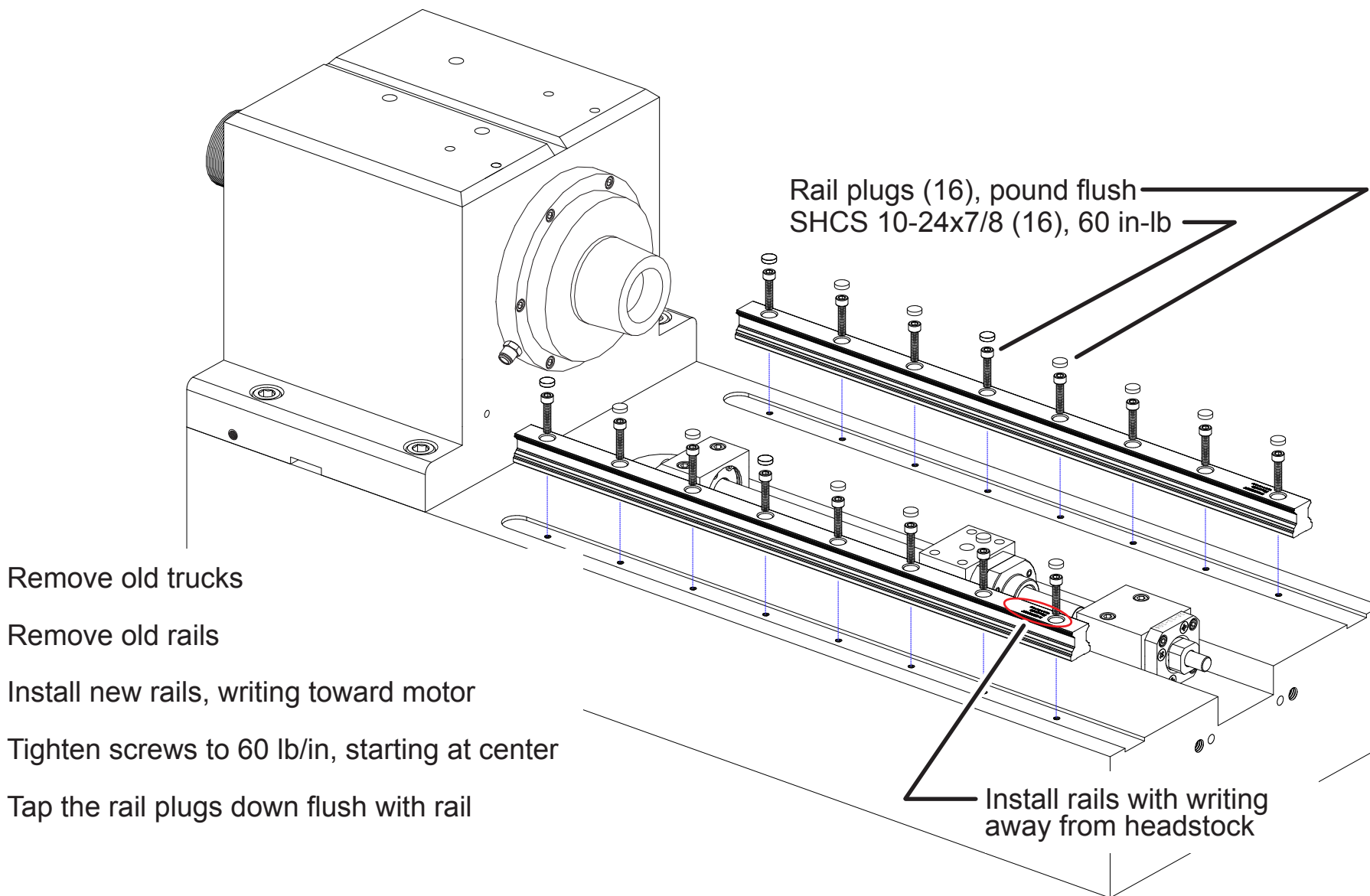

## Replace Z-axis Trucks

